



SKELL EFFEA

Space Innovation Forum 2021

Regional impact around Northvolt in Skellefteå

Ida Lindh-

Skellefteå kommun

Campus Skellefteå

PhD Entrepreneurship & Innovation





A new industrial era

SKILL
EFTEA

*75
billion SEK*

Estimated to be invested in Skellefteå until
2030 by public and private sector





10 billion

Schools, Port of Skellefteå, water plant, culture house (pic), travel centre, real estate, Skellefteå airport, renewable energy, and infrastructure

KULTURHUSET

SKELLEFTEÅ

An architectural rendering of a modern residential development. The scene features several multi-story apartment buildings in various colors: grey, orange, red, and white. The buildings have large windows and balconies. In the foreground, there is a lush green lawn with several trees and a paved walkway. A small bridge or ramp leads down to a body of water on the left. The sky is blue with scattered white clouds. The overall atmosphere is bright and sunny.

10 billion

Housing to cover the demand for new residents in new city central blocks and close to nature plots.

5000 new homes before 2030.

Pace: ca 300-500 /year



35 billion

Investments from the private sector



SKILL
EFTEA



5 billion

Infrastructure including the North Botnia
railway



A new industrial era

SKILL
EFTEA

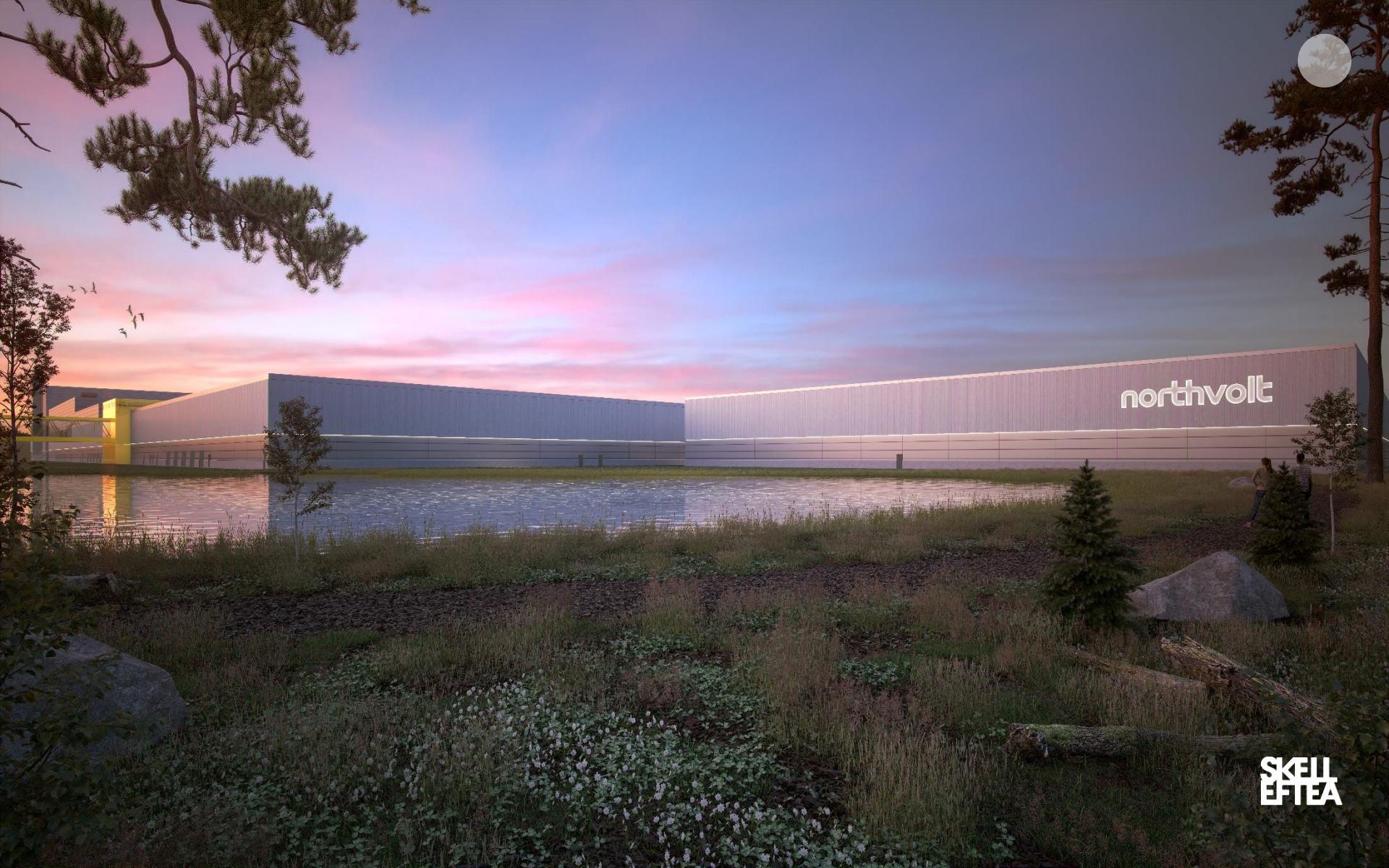

northvolt

SKILL
EFTEA



Vision 2030

**SKELL
EFTEA**

The background of the entire page is a vibrant, ethereal aurora borealis (northern lights) display. The colors range from deep, dark blues and purples to bright, glowing greens and yellows, with numerous small, twinkling stars scattered throughout the scene. The aurora appears as vertical, shimmering curtains of light that seem to dance across the sky.

Skellefteå

SKELLEFTEÅ

Make room for ideas.



RAW MATERIAL

Skellefteå

Skellefteå

RAW MATERIAL

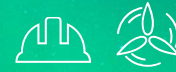

PRODUCTION

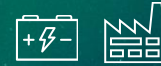

Skellefteå

RAW MATERIAL

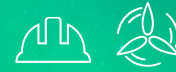

PRODUCTION

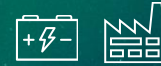

APPLICATION &
INTEGRATION



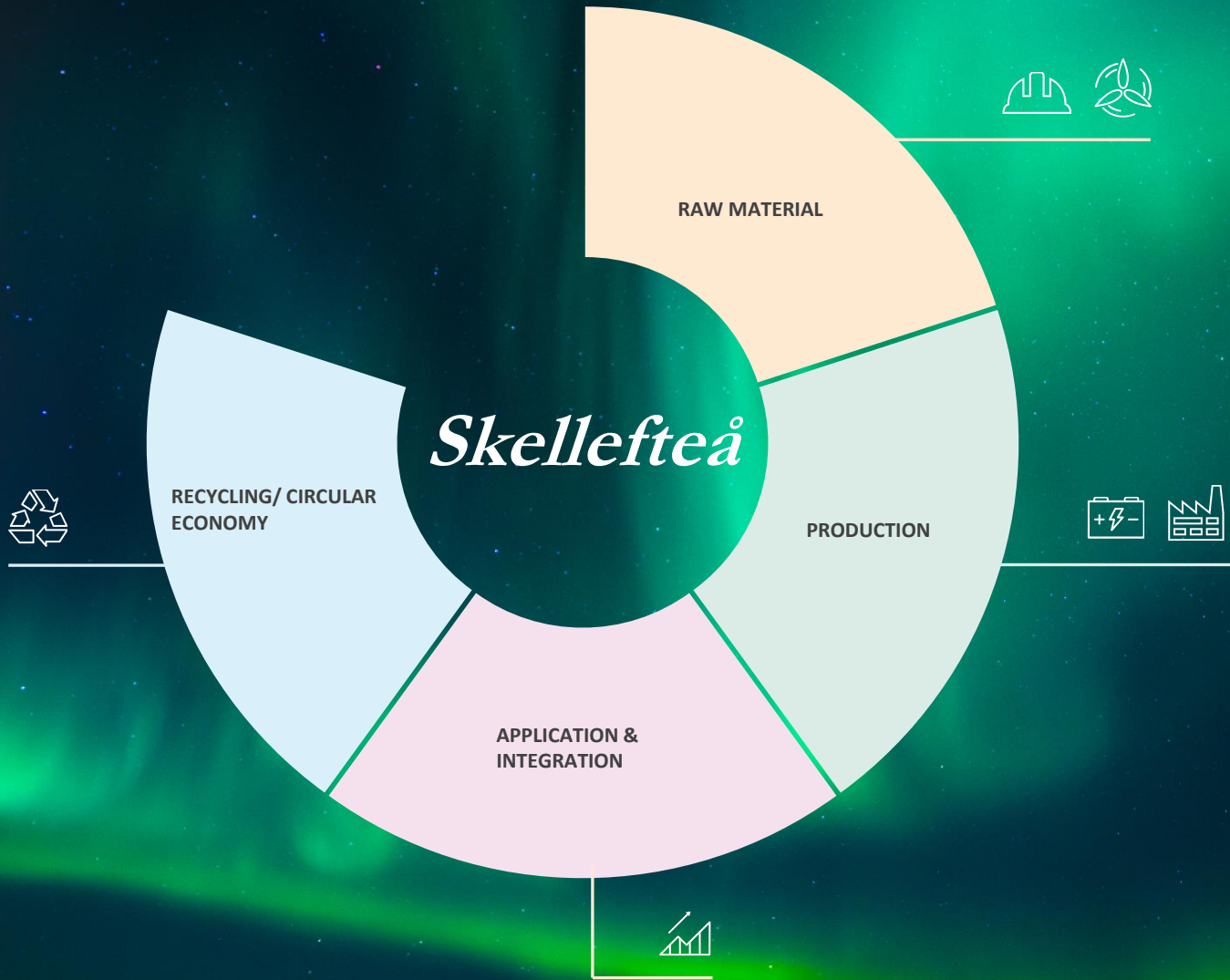

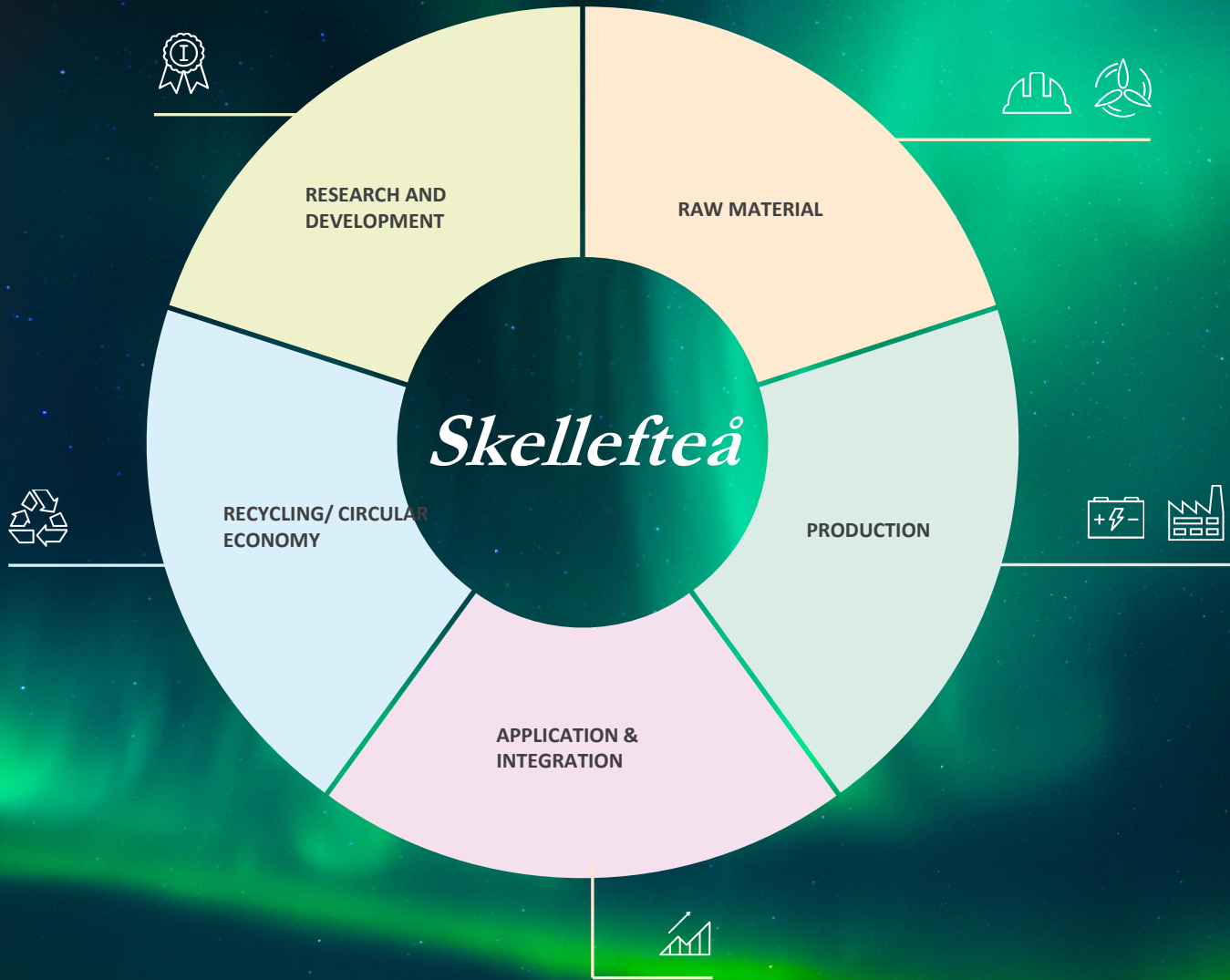

Skellefteå

RESEARCH AND DEVELOPMENT

RAW MATERIAL

PRODUCTION

APPLICATION & INTEGRATION

RECYCLING/ CIRCULAR ECONOMY



Challenges

3000 new jobs at Northvolt 2024

1500 new jobs related to sub-contractors

A growing business life in general

A growing Skellefteå

Skills and competence development

Talent attraction

Need for new life-long learning models

Arctic Center of Energy

Technology - Transformation - Transition

During 2020, Northvolt, RISE, LTU och Skellefteå entered a strategic partnership, with focus on education, research and development for the future of energy.



So, what about space?

**SKILL
EFTEA**

Make room for ideas.

SKELL
EFTEA



Ge idéerna plats.